



# DISCOVERY

## DVD System Owner's Manual

Publication Part No. LRL 0482

Published by Land Rover

© Land Rover 2001

All rights reserved. No part of this publication may be reproduced, stored in a retrieval system or transmitted in any form, electronic, mechanical, recording or other means without prior written permission from Land Rover.



As part of Land Rover's environmental policy, this publication is printed on paper made from chlorine free pulp.

## INTRODUCING THE DISCOVERY DVD SYSTEM

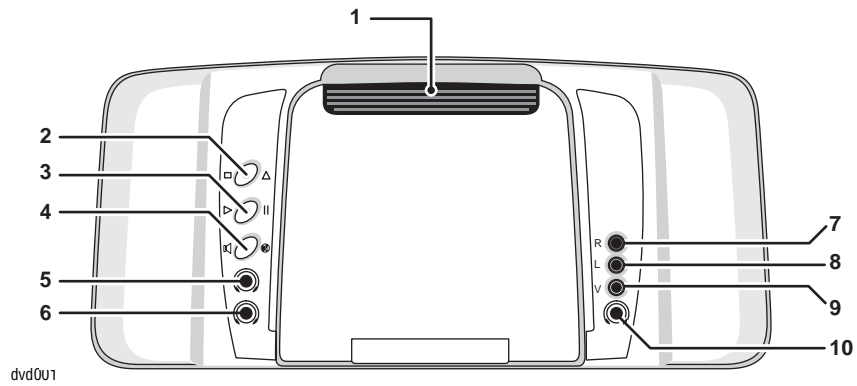

**1 MONITOR RELEASE LATCH**

**2 STOP/EJECT BUTTON**

**3 PLAY/PAUSE BUTTON**

**4 SPEAKER BUTTON**

**5 HEADPHONE JACK**

**6 HEADPHONE JACK**

**7 AUX INPUT**

**8 AUX INPUT**

**9 AUX INPUT**

**10 HEADPHONE JACK**

# Contents

---

## Discovery DVD System

INTRODUCTION .....	1
SWITCHING ON .....	1
MONITORS .....	1
USING THE HEADPHONES .....	2
USING THE CAR SPEAKERS .....	3
SWITCHING THE CAR SPEAKERS BETWEEN DVD AND CD .....	3
PLAYING THE RADIO .....	3
DVD CONSOLE BUTTONS .....	4
DVD REMOTE CONTROL .....	5
REPLACING THE BATTERIES .....	6
VIEWING A DVD .....	7
BASIC FUNCTIONS .....	8
BASIC FUNCTIONS, CONTINUED .....	9
USING AUDIO BUTTONS .....	10
DVD MENU BUTTONS .....	11
DVD LANGUAGE SUPPORT .....	12
PLAYING CDS .....	13
USING PARENTAL CONTROL .....	14
VIEW OPTIONS .....	15
USING GAMES AND CAMCORDERS .....	16
TROUBLESHOOTING .....	17
LOW VOLTAGE .....	17

# Discovery DVD System

## INTRODUCTION

The Discovery DVD system fitted to your vehicle has been chosen to give the occupants a more enjoyable journey.

Ensure that you and your passengers take time to read these instructions.

## Portable radios and telephones

When using portable radios and telephones near the unit, picture or sound interference may occur. Do not use these devices near this unit.

## SWITCHING ON

Use the DVD system when your vehicle is running or the starter switch is at position "I".

### IMPORTANT

- If your vehicle was parked in direct sunlight resulting in a considerable rise in temperature inside the vehicle, allow the unit to cool off before operating it.
- If temperature limits are exceeded, the DVD system automatically shuts down and ejects the DVD. When the temperature inside the vehicle returns to normal, power on the DVD system by pressing **POWER** on the remote control or opening and closing the monitor.

*Note: It is not advisable to use the DVD system for long periods without the engine running in order to avoid a dead battery.*

## MONITORS

Unlike conventional TV screens, Discovery DVD system monitors are Liquid Crystal Display (LCD) panels allowing for a compact, lightweight design. Because of this, the following should be observed:

- Do not press on the monitor unit; this can distort the picture or damage the LCD panel.
- Clean the LCD panel with a slightly damp, soft cloth using a mild household detergent.
- Do not use solvents such as benzene, thinner, commercially available cleaners or anti-static spray.
- Do not use this unit in temperatures under 0°C or over 80°C.
- If your car was parked in a cold or hot place, the picture may not be clear. **The monitor is not damaged.**

The picture will become clear after the temperature in your car returns to normal.

- Some stationary blue or red dots may appear on the monitor. These are called bright pixels and can happen with any LCD.

The LCD panel is highly sophisticated, and more than 99.99% of the pixels used are flawless. However, there is a possibility that less than 0.01% of these pixels are defective and may not light up properly. These defective pixels will not interfere with the picture.

# Discovery DVD System



## USING THE HEADPHONES

Using the Land Rover headphones with your DVD system allows rear-seat passengers to listen to their DVD or video game without disturbing front-seat passengers. When headphones are in use with the DVD system, front-seat passengers can use the vehicle's audio system as usual through the car speakers.

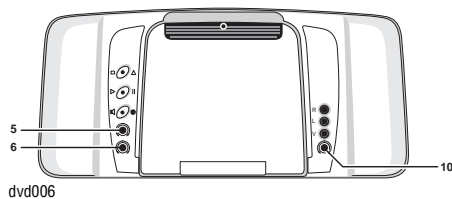

**5, 6, 10**  Stereo eighth-inch mini headphone jacks on the Discover DVD system console.

Plug headphones into any of the three headphone jacks on the DVD system console.

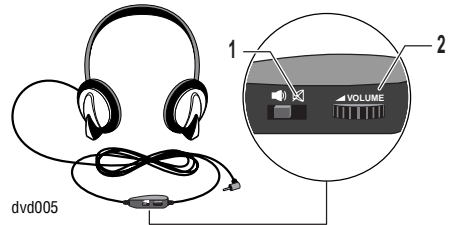

### 1 MUTE

Push to mute the headphones.

### 2 VOLUME CONTROL

Rotate the thumbwheel switch on the headphones to adjust the volume.

## RF Headphones



(Optional) Wireless radio frequency (RF) headphones may be available.

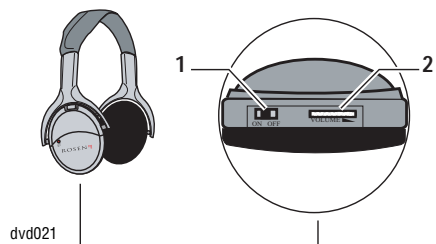

### 1 POWER ON/OFF

Push to turn headphones on and off.

### 2 VOLUME CONTROL

Rotate the thumbwheel switch on the headphones to adjust the volume.

# Discovery DVD System

## USING THE CAR SPEAKERS

To listen to the DVD through your car speakers, press the **CD** button on your vehicle's radio.

*Note: Installations vary. If you cannot find the CD button on your radio, consult your CD or radio user's guide.*

## SWITCHING THE CAR SPEAKERS BETWEEN DVD AND CD

While your car CD player is on, switch DVD audio to and from the car speakers by:

- pressing the  (SPEAKER) button on the DVD system console,  
or
- pressing **SPEAKER** on the remote control.

*Note: The CD player in your vehicle displays "CD"—regardless of whether the vehicle speakers are playing a CD or DVD.*

## PLAYING THE RADIO

While DVD audio is playing through the car speakers, you can return to AM/FM by pressing the AM/FM button on the radio. You can also return to playing a cassette tape by pressing the tape button or by inserting a cassette tape. To return to DVD audio, press the **CD** button on your vehicle's radio.

IMPORTANT
AFTER LISTENING to a DVD on your car speakers, you must press the  (SPEAKER) button on the DVD system console or <b>SPEAKER</b> on the remote control to switch the speakers back to CD audio. Pressing the CD button on your dashboard will NOT return your car speakers to CD.

# Discovery DVD System

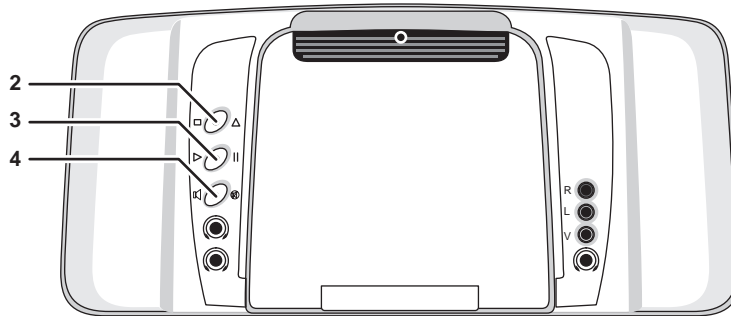

dvd007

## DVD CONSOLE BUTTONS

### 2 ■ / ▲ STOP/EJECT

Press to stop playback. *Stop* appears on the monitor. Press again to eject the DVD from the console. *Eject* appears on the monitor.

### 3 ▶ / || PLAY/PAUSE

Press to begin playback of the DVD. *Play* appears on the monitor. During playback, press to temporarily pause DVD playback. *Pause* appears on the monitor.

### 4 🔊 SPEAKER

When the car CD player is **ON**, press to hear DVD audio through the car speakers. *Speaker On* appears on the monitor. Press again to cease DVD audio through the car speakers. *Speaker Off* appears on the monitor.

# Discovery DVD System

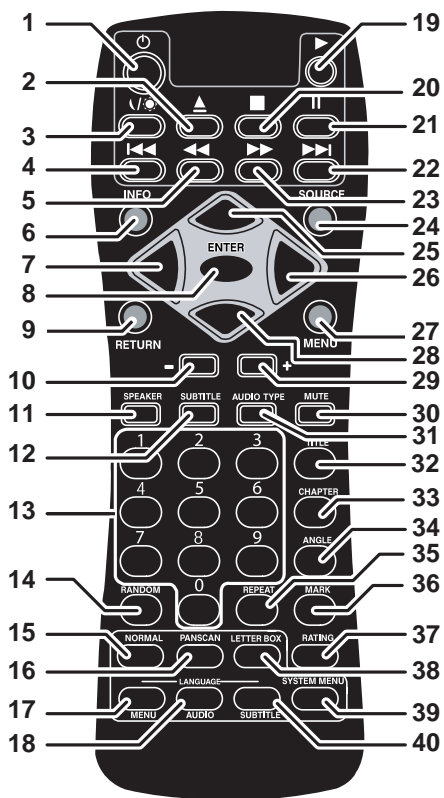

dvd008

## DVD REMOTE CONTROL

*Note: Adjust the volume using the volume control on the headphones or the car speaker volume control, not the remote control.*

### IMPORTANT

- Do not leave the remote control near any heat sources, or in a place subject to direct sunlight.
- When parked in direct sunlight, store the remote control in a shaded location, such as the glove box, to protect it from the heat.

- 1 Power
- 2 Eject
- 3 Day/Night Brightness
- 4 Previous Track
- 5 Reverse
- 6 Information
- 7 Left Arrow
- 8 Enter
- 9 Return
- 10 (Not Used)
- 11 Speaker
- 12 Subtitle
- 13 Number Keys
- 14 Random
- 15 Normal
- 16 Pan/Scan
- 17 Menu Language
- 18 Audio Language
- 19 Play
- 20 Stop
- 21 Pause
- 22 Next Track
- 23 Fast Forward
- 24 Source
- 25 Up Arrow
- 26 Right Arrow
- 27 Menu
- 28 Down Arrow
- 29 (Not Used)
- 30 Mute
- 31 Audio Type (Not Used)
- 32 Title Menu
- 33 Chapter Menu
- 34 Angle Menu
- 35 Repeat
- 36 Mark
- 37 Rating
- 38 Letter Box
- 39 System Menu
- 40 Subtitle Language

# Discovery DVD System

---

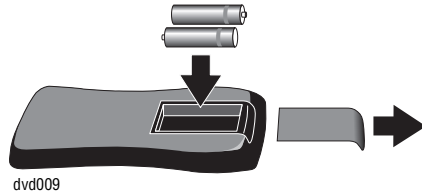

## REPLACING THE BATTERIES

Battery life is approximately six months depending on how often the remote is used. Use two size AAA batteries. Replace both batteries at the same time.

To avoid damage from battery leakage and subsequent corrosion:

- Insert the batteries matching the “+” and “-” on the batteries to the “+” and “-” in the battery compartment.
- Do not use an old battery with a new one, or different brands of batteries together.
- Remove the batteries when the unit is not being used for long periods of time.
- DO NOT charge the batteries.

If battery leakage occurs, replace all the batteries with new ones after cleaning the battery compartment.

# Discovery DVD System

## VIEWING A DVD

*Note: When using the remote control, always aim at the sensor located in the console above the monitor.*

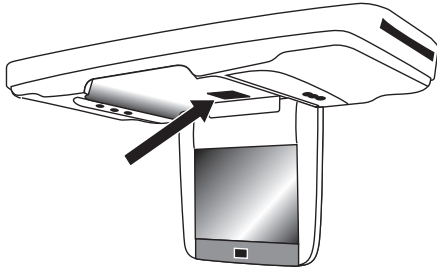

dvd018

- 1 Switch on the vehicle, or turn the starter switch to the "I" position.
- 2 Open the monitor and adjust the viewing angle.

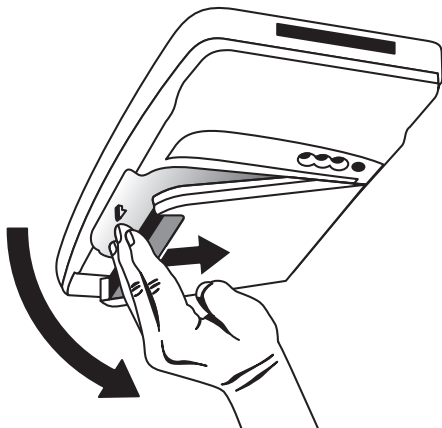

dvd003

- 3 Adjust the angle of the monitor for viewing from the rear car seats.

### IMPORTANT

The monitor will go blank if it is pushed too far toward the front of the car. Video returns when you adjust the angle for normal viewing.

- 4 Insert a DVD or CD label side up into the slot on the side of unit.

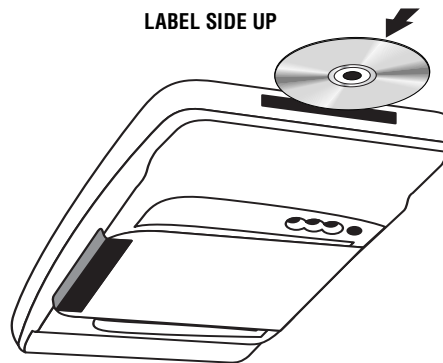

dvd002

### IMPORTANT

DVD playback varies from disc to disc.

Options include:

- DVD playback begins automatically when you insert the disc.
- DVD playback begins automatically, but proceeds only until a menu of options appears. To continue playback, highlight an option using the arrow buttons then press **ENTER** on the remote control.
- The DVD displays a menu of options before proceeding. To continue, highlight an option using the arrow buttons then press **ENTER** on the remote control.

# Discovery DVD System



dvd010

## BASIC FUNCTIONS

### 1 POWER

While the Discovery DVD system monitor is open in the viewing position, press to turn on and off the system.

The DVD system automatically turns on and off when the monitor is opened and closed.

### 2 EJECT

Press to eject the DVD or CD. *Eject* appears on the monitor.

### 3 DAY/NIGHT BRIGHTNESS

Press to switch brightness for day or night viewing. *Day* or *Night* appears on the monitor.

### 19 PLAY

Press to play DVD or CD.

### 20 STOP

Press to stop playback of the DVD or CD. *Stop* appears on the monitor.

To resume normal playback, press  **PLAY**.

### 21 PAUSE

Press to temporarily pause playback. *Pause* appears on the monitor.

To resume normal playback, press  **PLAY**.