

WHAT COMES IN THE BOX

- 1 1 camera arm
- 2 1 camera arm mounting plate
- 3 1 control pad
- 4 1 control pad mounting plate
- 5 1 color printer with power cable and two starter ink cartridges
- 6 1 Bluetooth wireless printer adapter*
- 7 1 ethernet cable
- 8 1 power adapter and cord
- 9 1 camera arm positioning template
- 10 1 control pad positioning template
- 11 5 four-foot sections of cable raceway (for concealing cables)
- 12 2 cable raceway tees
- 13 4 cable raceway elbows
- 14 6 calibration sheets (4 corner sheets, one whiteboard, one blackboard sheet)
- 15 4 border buttons
- 16 4 #8 x 1.5 inch drywall screws
- 17 7 toggle bolts
- 18 7 toggle bolt screws (10-24 x 1.25 inch)
- 19 3 arm-securing screws
- 20 1 Installation Guide (this guide)
- 21 1 User Guide
- 22 1 web server configuration CD-ROM
- 23 1 registration card

NOTE:

**Your CopyCam includes either a printer already enabled for Bluetooth wireless communication, or a standard color printer and a Bluetooth wireless adapter. Both printer configurations work identically and print at the same speed.*

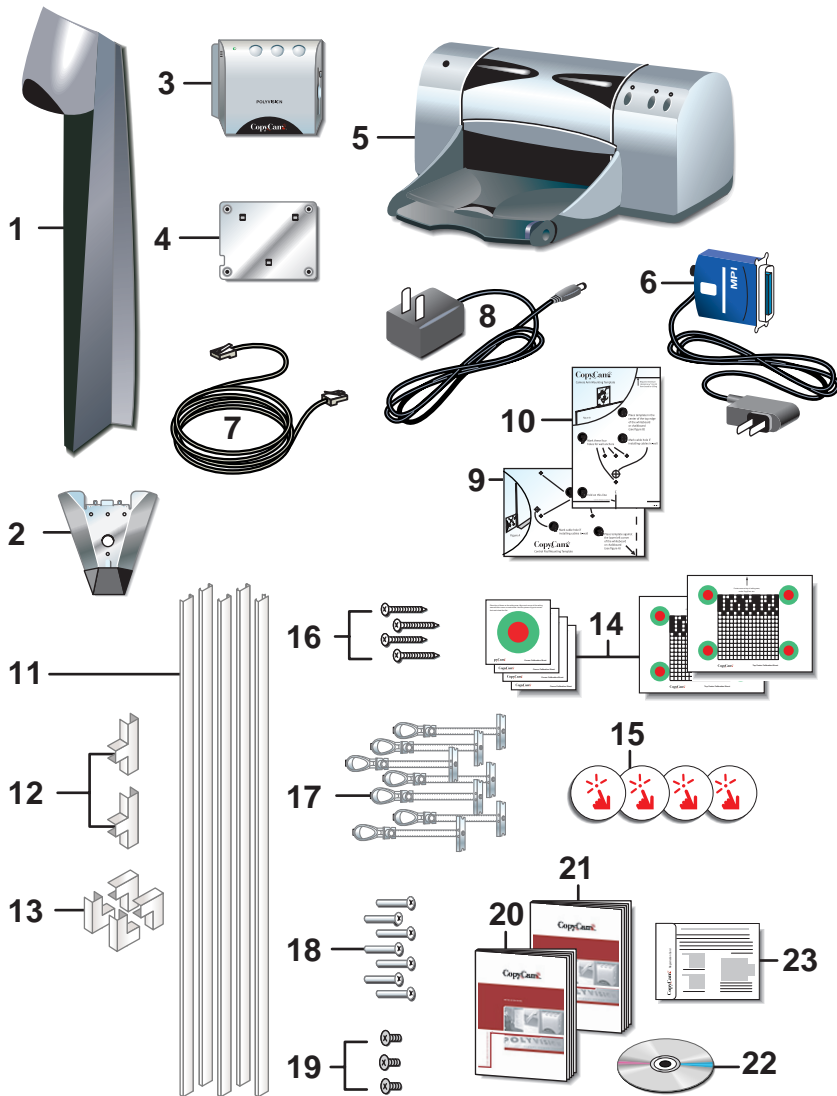

SPATIAL REQUIREMENTS

CopyCam components use space above the board and to the left of the board.

WARNING

A minimum of 14.1 inches above the board is required for installation of the camera arm, as shown below. If you do not have at least 14.1 inches of clearance, do not attempt to install CopyCam. Consider the possibility of moving your board down, or, with a false ceiling, of raising the ceiling.

Remove projection screens, maps or other devices above the board that can interfere with the camera arm position.

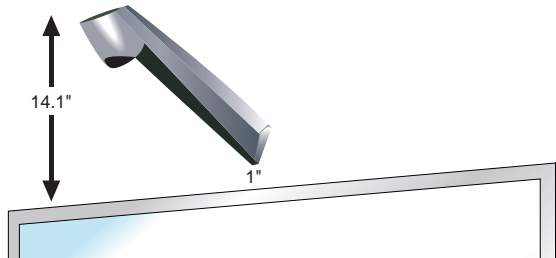

The control pad includes a floppy diskette drive that the user accesses from the right. The preferred location for the control pad is four inches to the left of the board, and about five inches above the bottom of the board, as shown below.

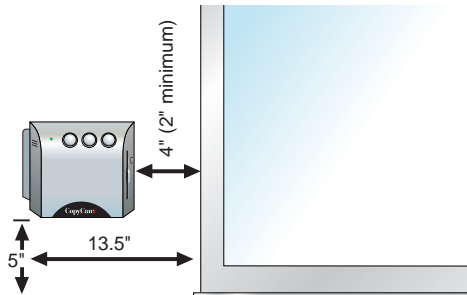

MOUNTING THE CONTROL PAD AND CAMERA ARM

Expect to spend about two hours on this installation.

PLANNING FOR WIRING

CopyCam has three cable connections that converge in the camera arm, as shown below.

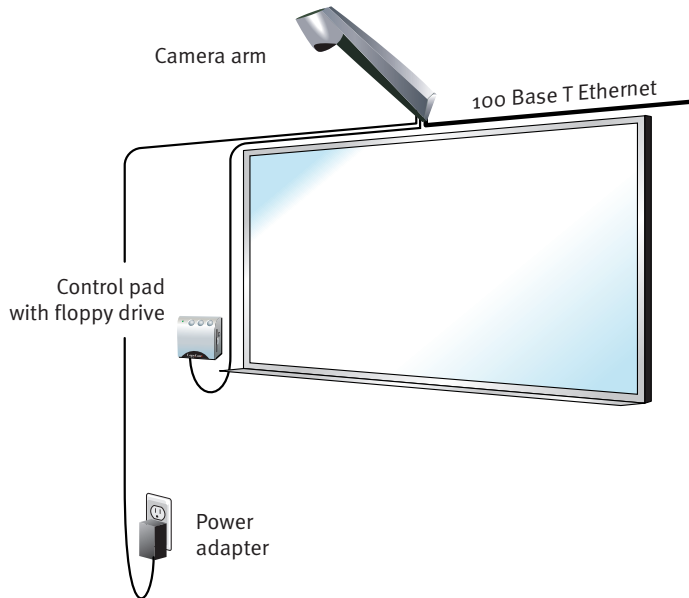

CopyCam wiring can be either:

- against a wall, the typical approach for adapting an existing facility, or
- within a wall, a potential for new construction or renovation

NOTE:

Use the positioning templates provided to assure proper location of the control pad and camera arm. Failure to do so may result in inhibited access to the floppy disk drive in the control pad, or in incomplete copies of the board.

MOUNTING COPYCAM AGAINST THE WALL

Instructions below provide details for routing cables against the wall. Refer to “Routing Cables Within the Wall” on page 20 for differences when installing cables within a wall.

PREPARING TO INSTALL THE CONTROL PAD

WARNING

You must fasten the brackets to the wall so they are secure. CopyCam mounts to any kind of wall construction. Instructions and wall fasteners are provided to help you install CopyCam when walls have metal or wood studs. Be sure to locate studs and use them to drive mounting screws whenever possible.

Locate and have ready to use:

- control pad positioning template
- control pad
- control pad mounting plate
- 2 #8 x 1.5 drywall screws (provided)
- 4 toggle bolts (provided)
- 4 toggle bolt screws (provided)
- power drill with 1/2 inch (12.5mm)
- power screwdriver with phillips bit, or phillips screwdriver
- pencil
- tape measure (optional)

INSTALLING THE CONTROL PAD MOUNTING PLATE

These instructions guide you through installing CopyCam on a sheetrock wall. If your wall material is some other substance, such as concrete or brick, use these instructions as a guideline but install appropriate anchors to secure the unit to the wall.